

# SYMPOSIUM

STATION-BERLIN | EIGHT HALLS, 23.000 SQUARE METRES OF SPACE. INFINITE POSSIBILITIES.



STATION BERLIN

# SYMPOSIUM

## GROUND PLAN

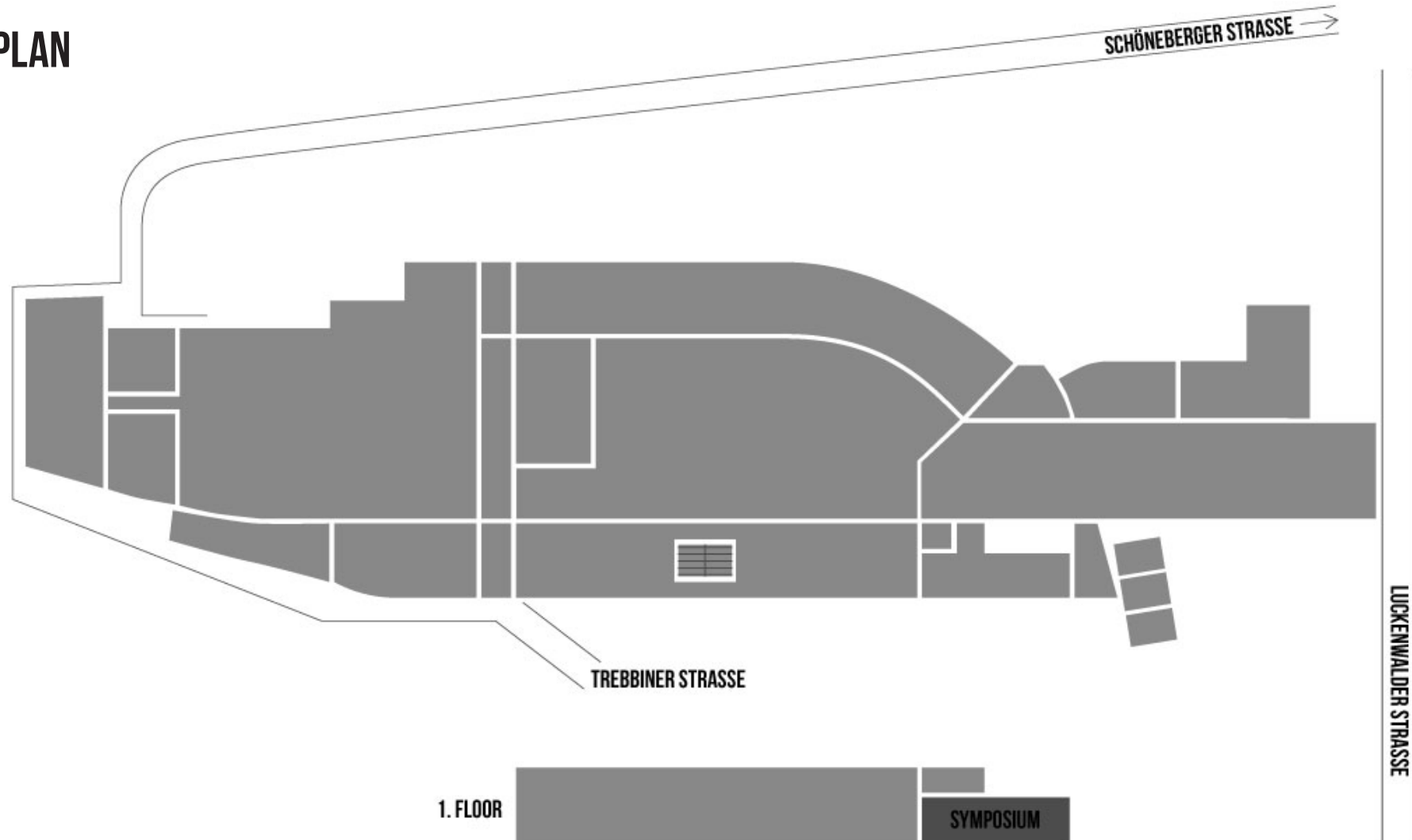





# SYMPOSIUM

## INFO

The 264 square metre Symposium is flooded with light and immediately creates a feel-good vibe.

It can be accessed both via the adjacent Hall 5 on the first floor and via the adjoining roof terrace. High vaulted ceilings, wooden floor and extraordinary windows give it a special atmosphere.





# SYMPOSIUM

## USE

The Symposium is particularly suitable for smaller conferences or board meetings. At the same time, the room offers an ideal setting for dinner events, press conferences, workshops and many other formats.





# SYMPOSIUM

## FACTS

Floor space	264 sqm
Maße	24,3 x 10,9 m
Clearance height	7,70 m
Lamp height	4,50 m
Beam height	4,70 m
Level	First Floor
Barrier-free access	No
Disabled toilet	No

## SEATING\*

Row	170 pax
Banquet	120 pax
Without seating	290 Standing

\*Reference point. The maximum room capacity depends on the specific room concept and has always be considered individually.

## OTHER

Power	Yes
Water	Yes
LAN/WiFi	Yes/Yes
Truck/car access (via ramp)	No/No
Heating/Cooling	Yes/No
Blackout	Optional