

VIADUCT

STATION BERLIN | EIGHT HALLS. 23,000 SQUARE METRES OF SPACE. INFINITE POSSIBILITIES.



STATION BERLIN

VIADUCT

GROUND PLAN

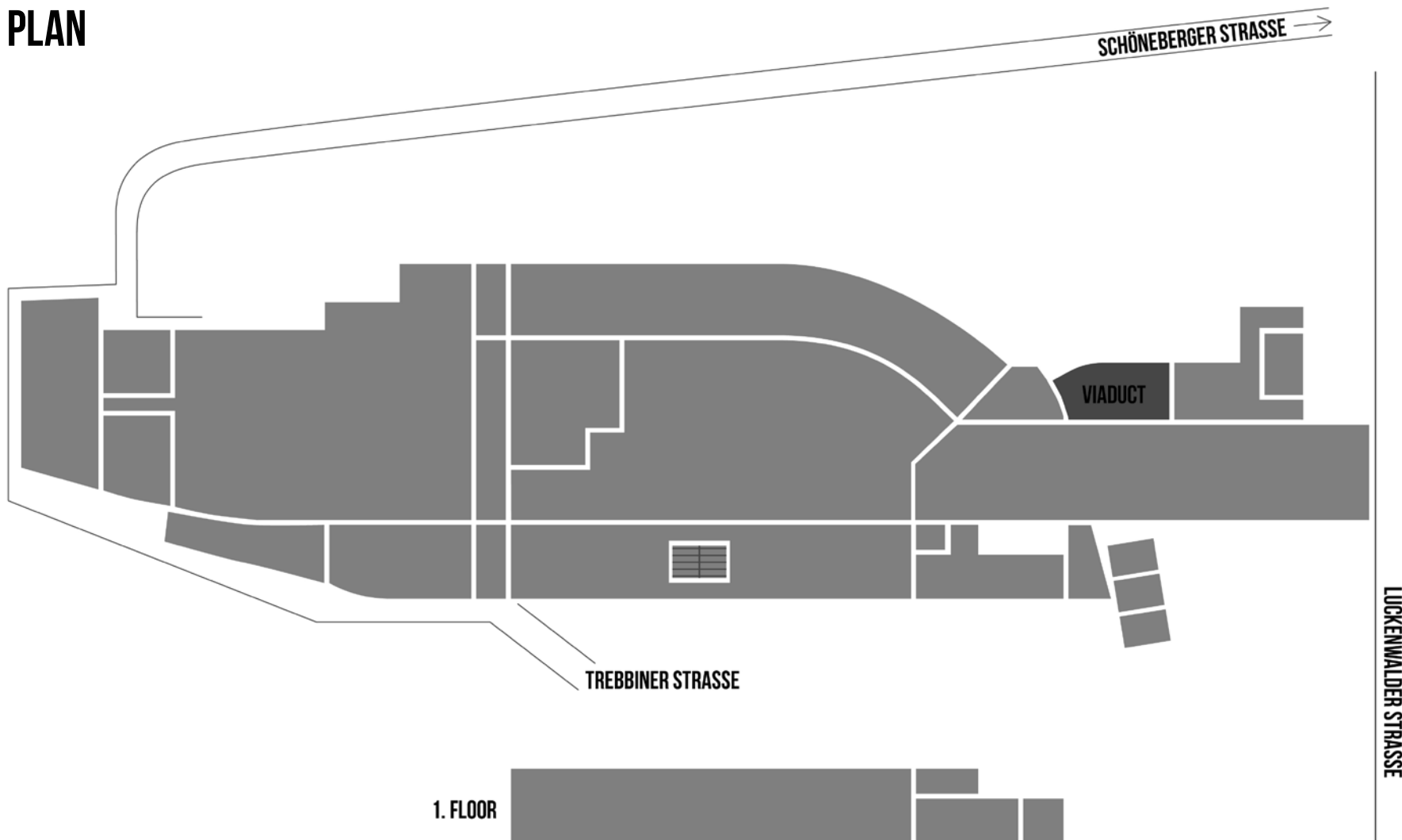



VIADUCT

INFO

Exclusive events deserve exclusive spaces. The Viaduct is truly one-of-a-kind. And not just in Berlin.

With a clearance height of 11.2m, this industrial structure delivers an atmosphere of veritably ecclesiastical dimensions. The Viaduct is both an impressive foyer for each of the Halls, and can also serve as an event space by itself.



VIADUCT

USE

With its clearance height of 11.2m, this structure embodies an industrial architecture of virtually ecclesiastical proportion.

Simultaneously, the walls of historic masonry imbue it with warmth and intimacy.

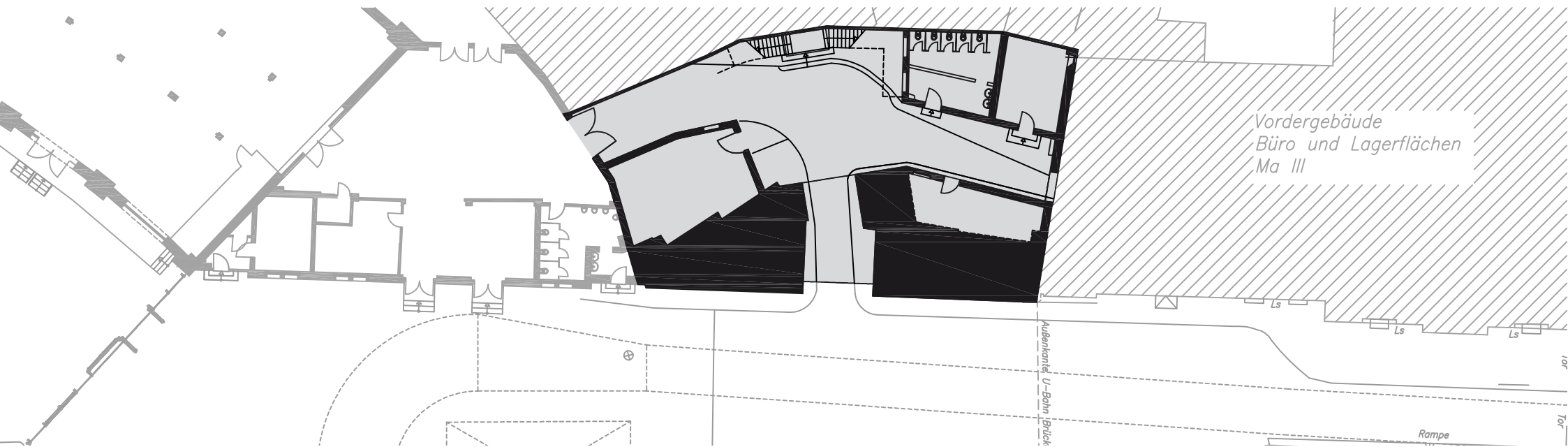

VIADUCT

FACTS

Floor space	182m ²
Clearance height	11.20m
Level	Ground Floor

SEATING

Banquet	120 Seats
Without seating	182 Standing

OTHER

Power	Yes
Water	Yes
LAN/WiFi	Yes/Yes
Truck/car access (via ramp)	No/Yes
Heating/Air Conditioning	Yes/No
Blackout	No