

HALL 6

STATION BERLIN | EIGHT HALLS. 23,000 SQUARE METRES OF SPACE. INFINITE POSSIBILITIES.



STATION BERLIN

HALL 6

GROUND PLAN

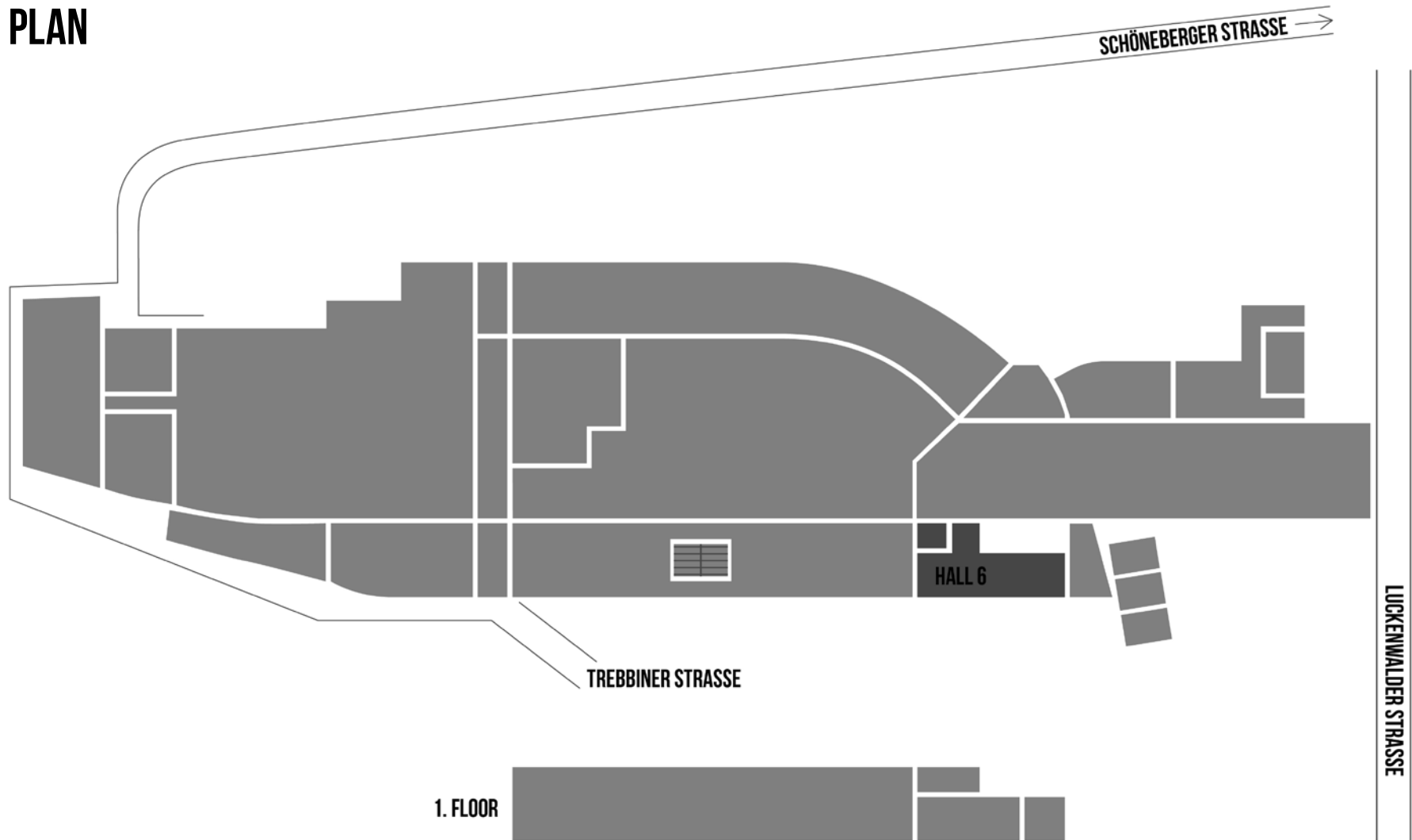



HALL 6

INFO

The golden walls create an appealing atmosphere for extraordinary product presentations, customer events and team events for up to 500 individuals.

The hall is also the perfect reception space in combination with the use of Halls 4 and 5.



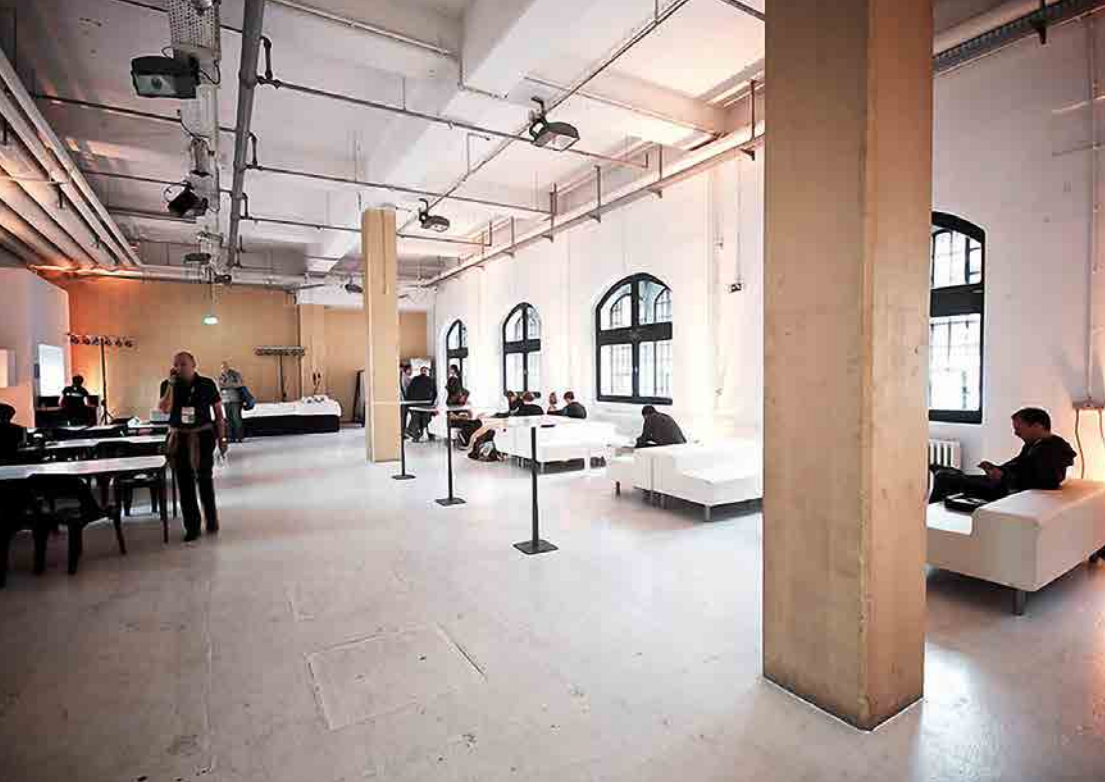

HALL 6

USE

Whatever the size of your event—a formal dinner, a showroom, a small event or an entrance hall for the spaces that lie behind it—Hall 6 is amazing in every respect and, upon request, it can be made accessible from a larger area, that is, from the inner courtyard by using multiple gates.

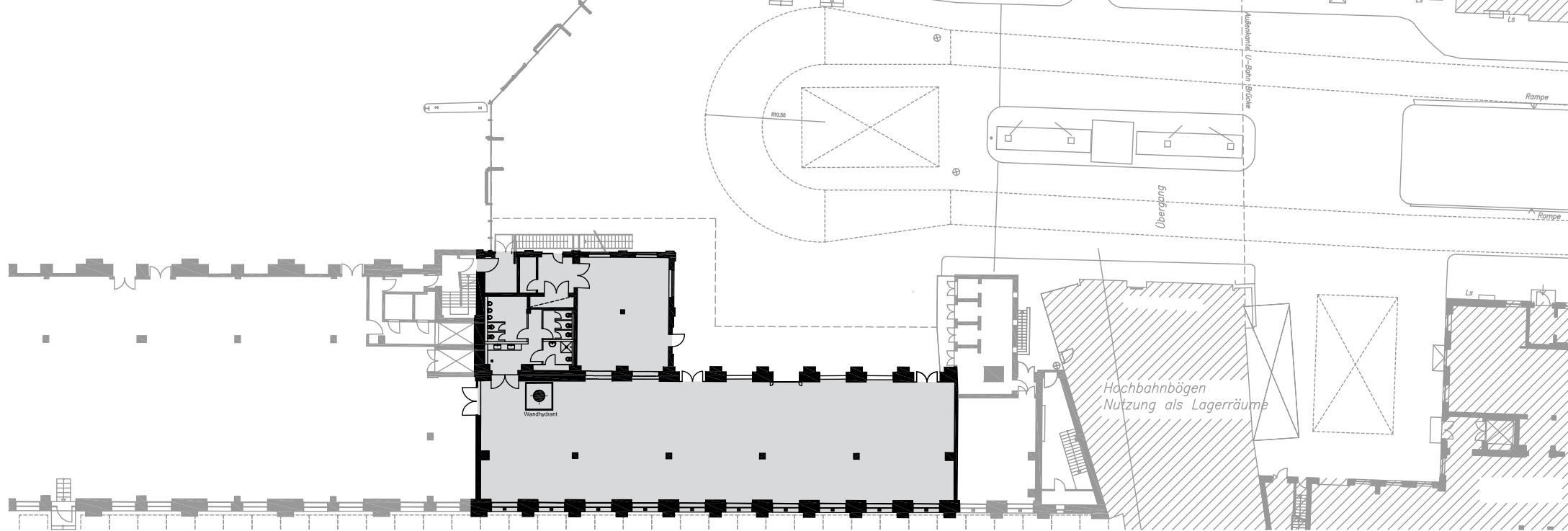

HALL 6

INFO

Floor space	500m ²
Dimensions	41 x 10m
Clearance height	5.20m
Lamp height	4.30m
Level	Ground Floor

SEATING

Theatre	300 Seats
Gala	200 Seats
Banquet	300 Seats

OTHER

Power	Yes
Water	Yes
LAN/WiFi	Yes/Yes
Truck/car access (via ramp)	No/Yes
Heating/Air Conditioning	Yes/No
Blackout	Optional